

Sketch SF!

Drawn through the Heart of San Francisco



with Chip Sullivan, Bob Chipman, Richard Alomar and Jim Richards
FRI FS-09 Friday, November 11, 9:00 am - 4:30 pm Moscone Center room 101

Sketch SF

Drawn through the Heart of San Francisco

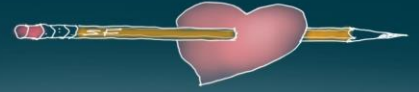

Tour Leaders:

Richard Alomar, Bob Chipman, Jim Richards, Chip Sullivan

Starting location time + location:

Friday, November 11 at 9:00am
Moscone Convention Center, room 101

Welcome again sketching colleagues, to the 10th year of the *Sketch!* field sessions at the ASLA Conference. This year, in the City by the Bay, we'll delve into the history of some of its urban plazas, to discover what drove their designs and analyze what has and hasn't worked over the years as urban design has continued to evolve. Using our drawing skills as observational tools we plan to take some visual notes from our local cartoonist professor Chip Sullivan, who has studied these urban spaces throughout his years living in the Bay area. We'll learn some landscape architectural history as we get familiar with some of San Francisco's downtown structure, and record the day's journey.

"Exploring and sketching the city is a way to see your surroundings in new ways, heighten your observational skills and refill your creative well. And it's arguably the very best way to build your own mental image bank that's the designer's inner sourcebook of ideas." ----Jim Richards

The session will begin with a hearty welcome and short description of the day's events plus some short drawing discussions in the conference center. After reviewing some journaling techniques, getting a few drawing tips and reviewing the sketch route we'll head out into a string of park and plaza spaces that represent a cross-section of urban development in San Francisco, primarily older projects from the mid to latter 20th century.

Here's a list of materials to bring and the tour's route/timetable below to get geared up for the event. We hope everyone will have a great time and look forward to seeing you!

Personal gear:

Comfortable walking shoes (there's a fair bit of walking this year)
Light overcoat or jacket and a warm layer for SF weather
Sunscreen (needed if we're lucky)
Water + snacks (water bottle provided)
Small courier bag or backpack to carry all this stuff
Folding camp stool (optional)

Sketching supplies:

Accordion Sketchbooks (provided by ASLA)
Favorite pencils + pens
Gray toned markers (a special focus by Jim this year)
Colored pencils and other color media
Fountain pen (optional)
Eraser/sharpener
Glue stick or tape for collages
Possibly watercolor gear (though this year we will NOT be using watercolor paper)
Any of your other favorite Plein-Air drawing supplies

Box lunches will be provided at one of the park stops, so we can keep drawing as we eat. Then after our last stop, we'll head to a great local pub with outdoor tables where we can gather, have some refreshments, and finish working on our sketchbooks, before heading back to the Moscone Center.

Field session timetable + route:

9:00-9:30	Intro & lecture in room 101 Moscone Center
9:30-9:40	Leave lecture room & head to Yerba Buena Gardens
9:40-10:15	Drawing panoramic thumbnails - <i>Richard Alomar exercise</i>
10:15-10:40	Leave park for Market St & catch BART to Embarcadero
10:40-11:15	Ferry Building / Embarcadero Plaza demo & drawing - <i>Jim Richards demo</i>
11:15-11:55	Embarcadero Plaza / Vaillancourt Fountain- <i>Chip Sullivan intro</i>
11:55- 12:05	Walk to Sydney Walton Park
12:05-12:10	Pick up box lunches in park [<i>delivered</i>]
12:10-12:15	Intro to park history - <i>Chip Sullivan</i>
12:15-1:00	Eat lunch & draw Sydney Walton Square
1:00-1:15	Leave park & walk to Levi's Plaza
1:15-2:00	Draw at Levi's Plaza & park - <i>Bob Chipman intro</i>
2:00-2:20	Walk to One Bush Plaza, Zellerbach Building
2:20-3:00	Draw plaza - <i>Chip Sullivan intro</i>
3:00-3:15	Review sketchbooks & summary
3:15-3:20	Head to the Irish Bank pub
3:20-4:00 +	Drink & Draw
4:00	Collect sketchbooks & return to Moscone Center

Contact information:

Chip Sullivan	csully@berkeley.edu	510.292.0536
Robert Chipman	rgchipman@gmail.com	512.596.3569
Richard Alomar	Richard.Alomar@rutgers.edu	917.224.8373
Jim Richards	jim@townscape.com	817.999.1522

Sketch SF

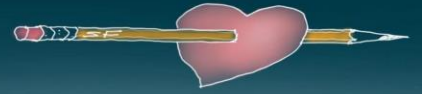

Drawn through the Heart of San Francisco



Route Map

FIELD SESSION FS-07 with Chip Sullivan Bob Chipman Richard Alomar and Jim Richards

Here are a few notes and drawings of the places on the route to lend a little history and inspiration for our upcoming session:

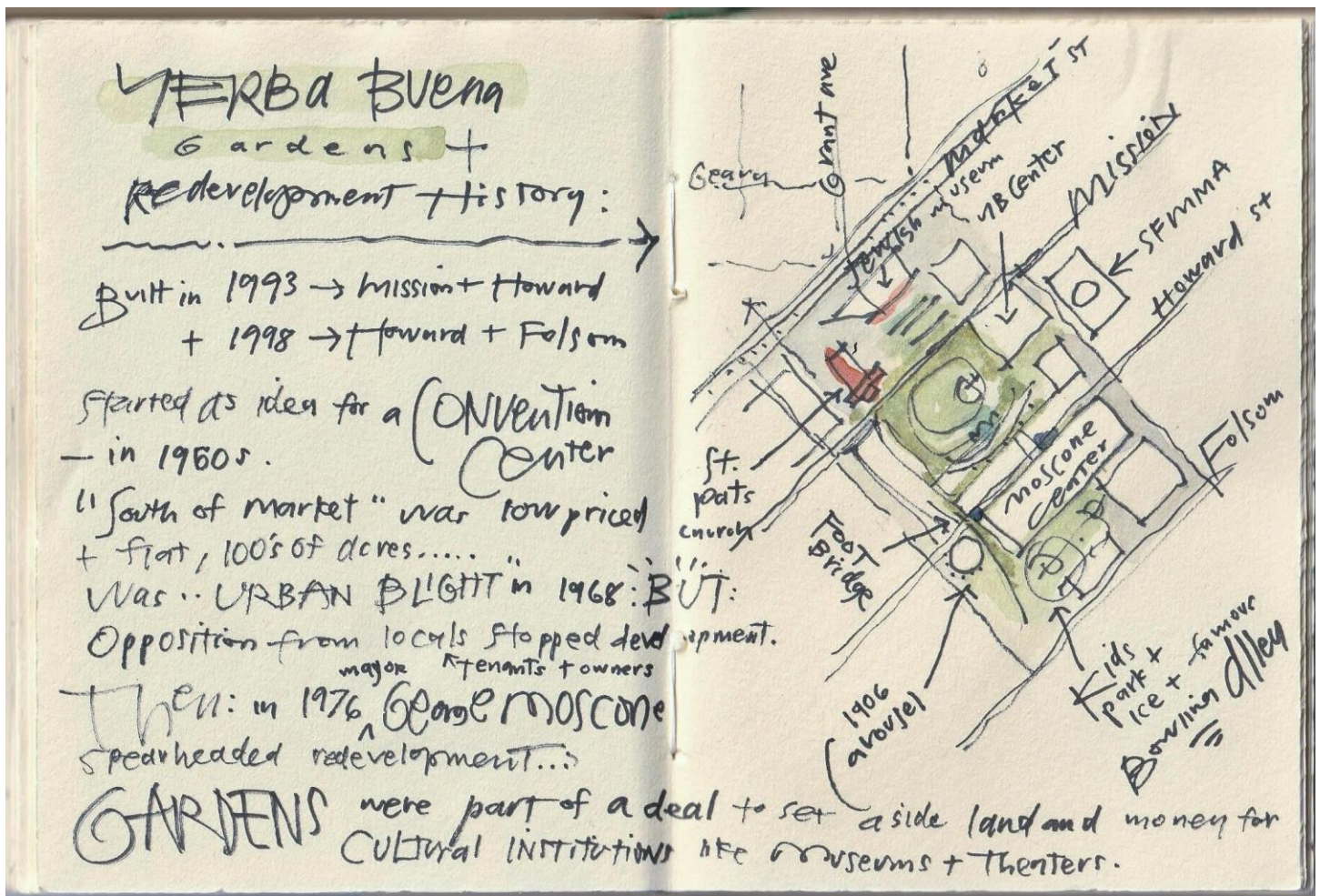

Yerba Buena Gardens

1990s redevelopment with convention center and cultural improvements

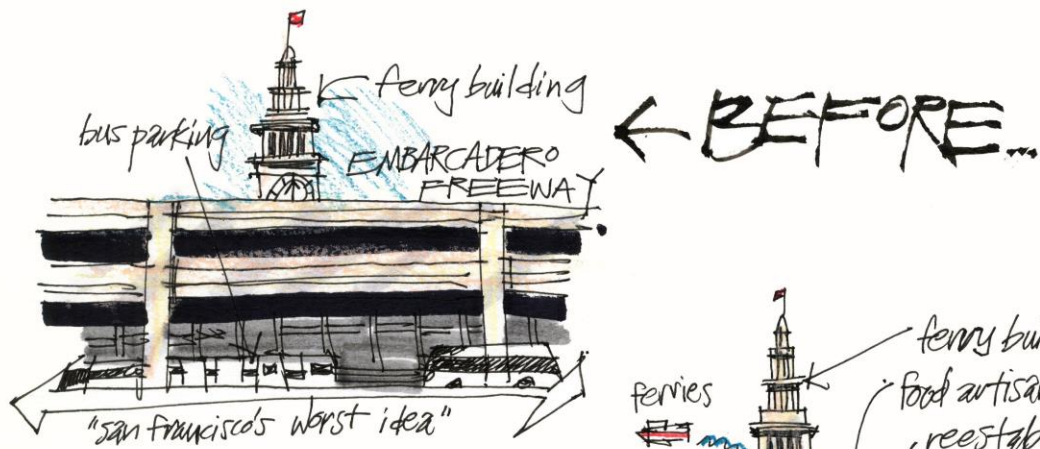

AFTER...

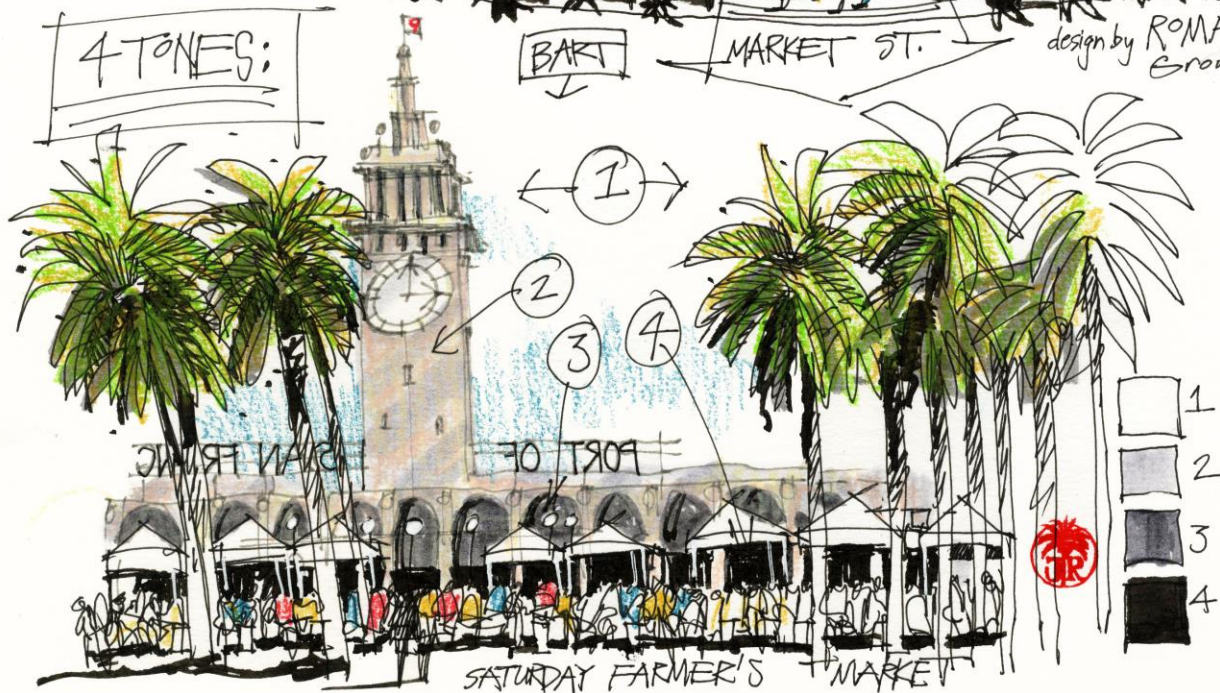
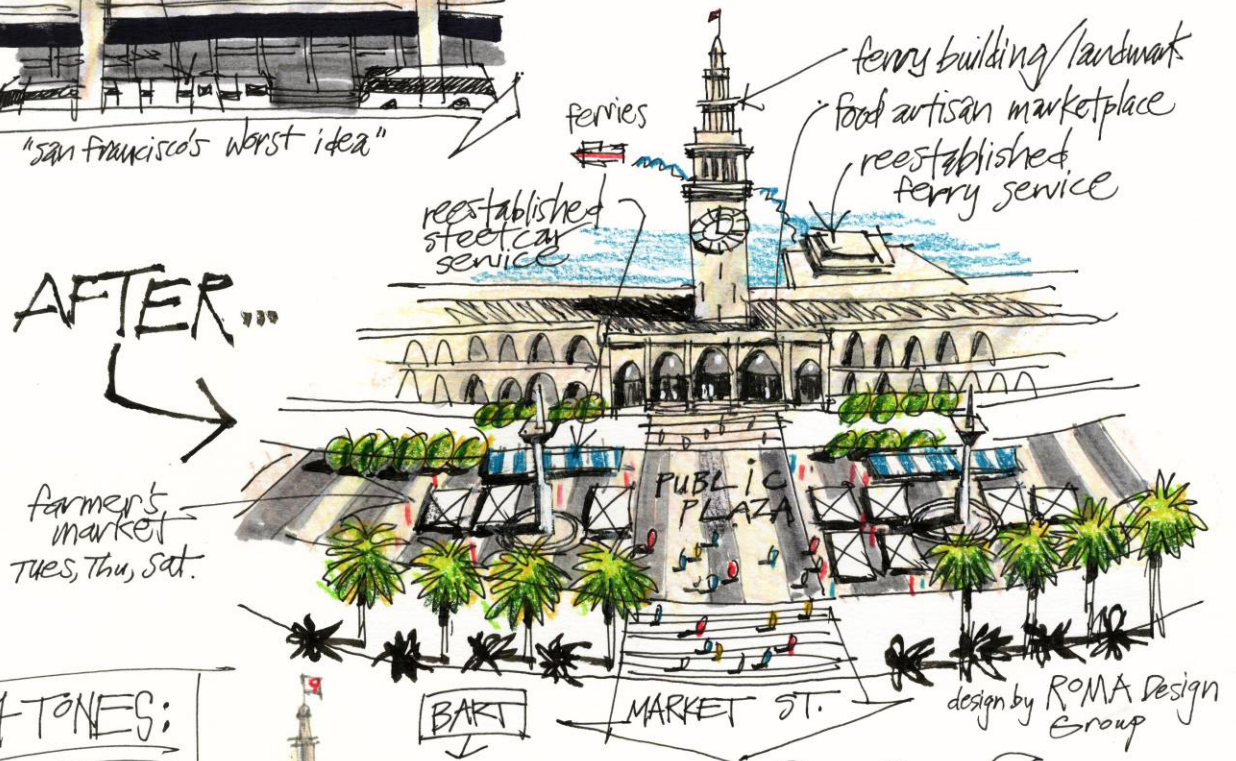

Ferry Building / Embarcadero Plaza

Freeway removed, Ferry building renovated into shops, market plaza, transit hub reestablished

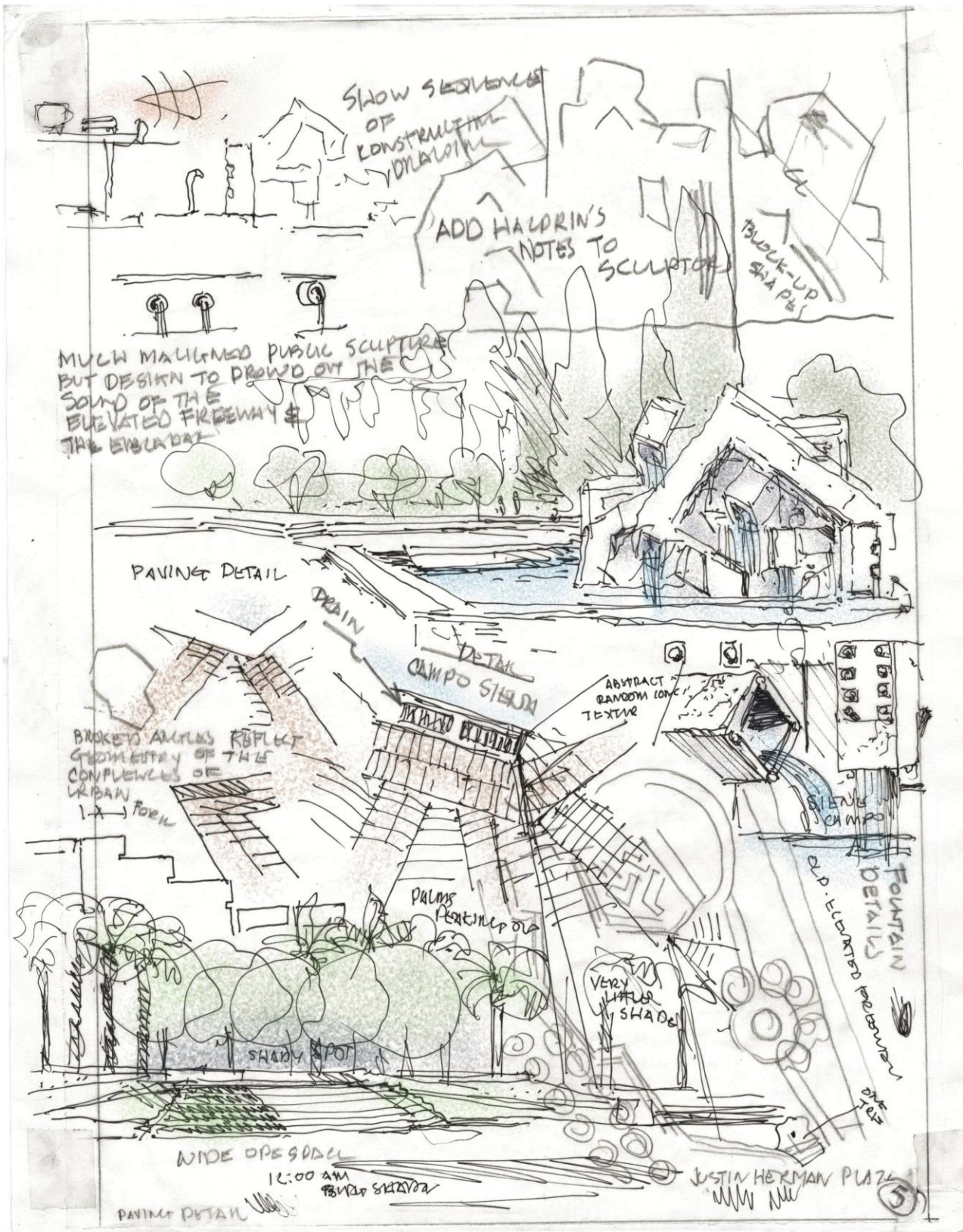

Vaillancourt Fountain / Embarcadero Plaza

Piazza del Campo (Siena) paving patterns, tiny shade & the thunderous roar of water

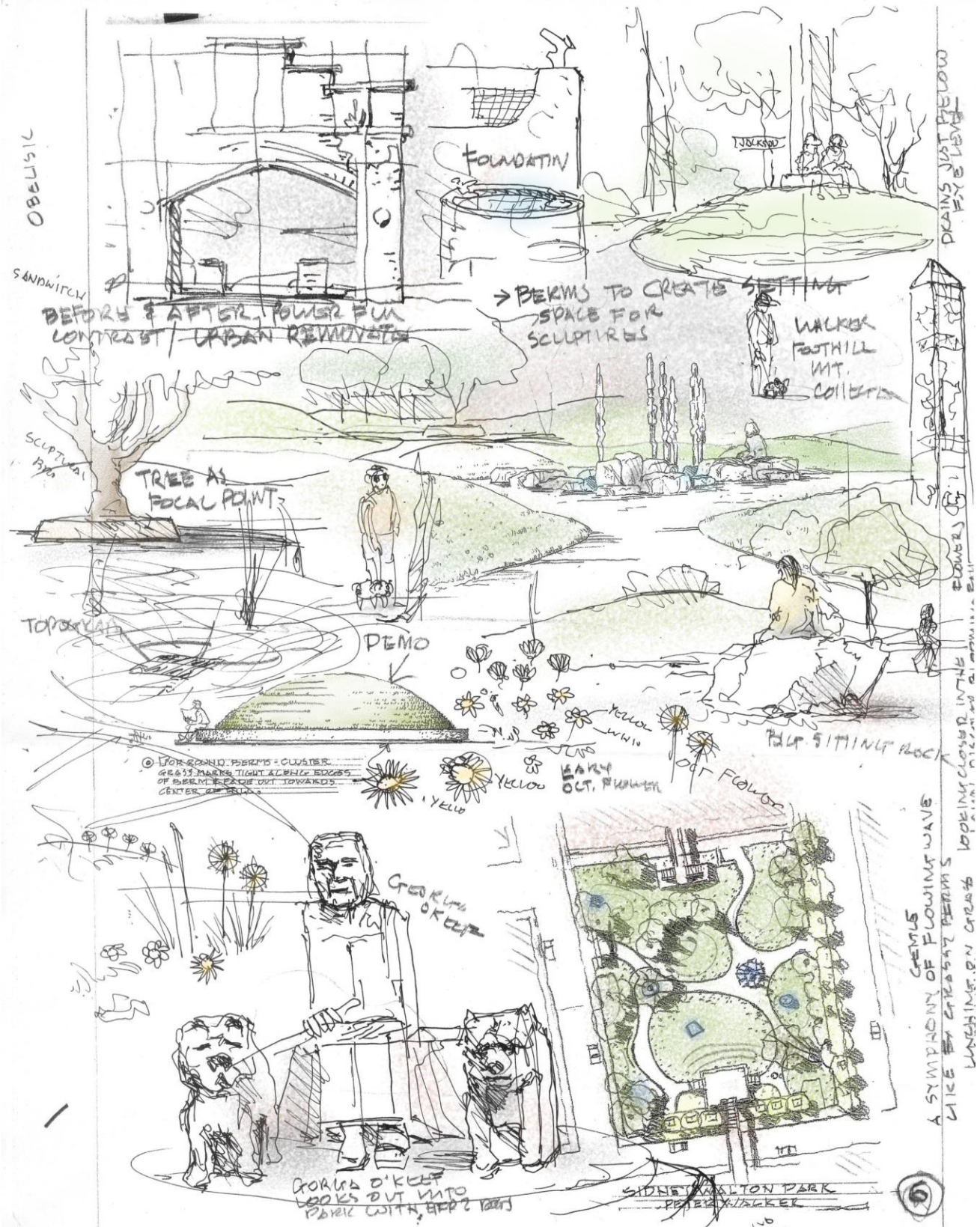

Sydney Walton Plaza

Remains of the Italian food market, mounds, flowers & sculptural niches

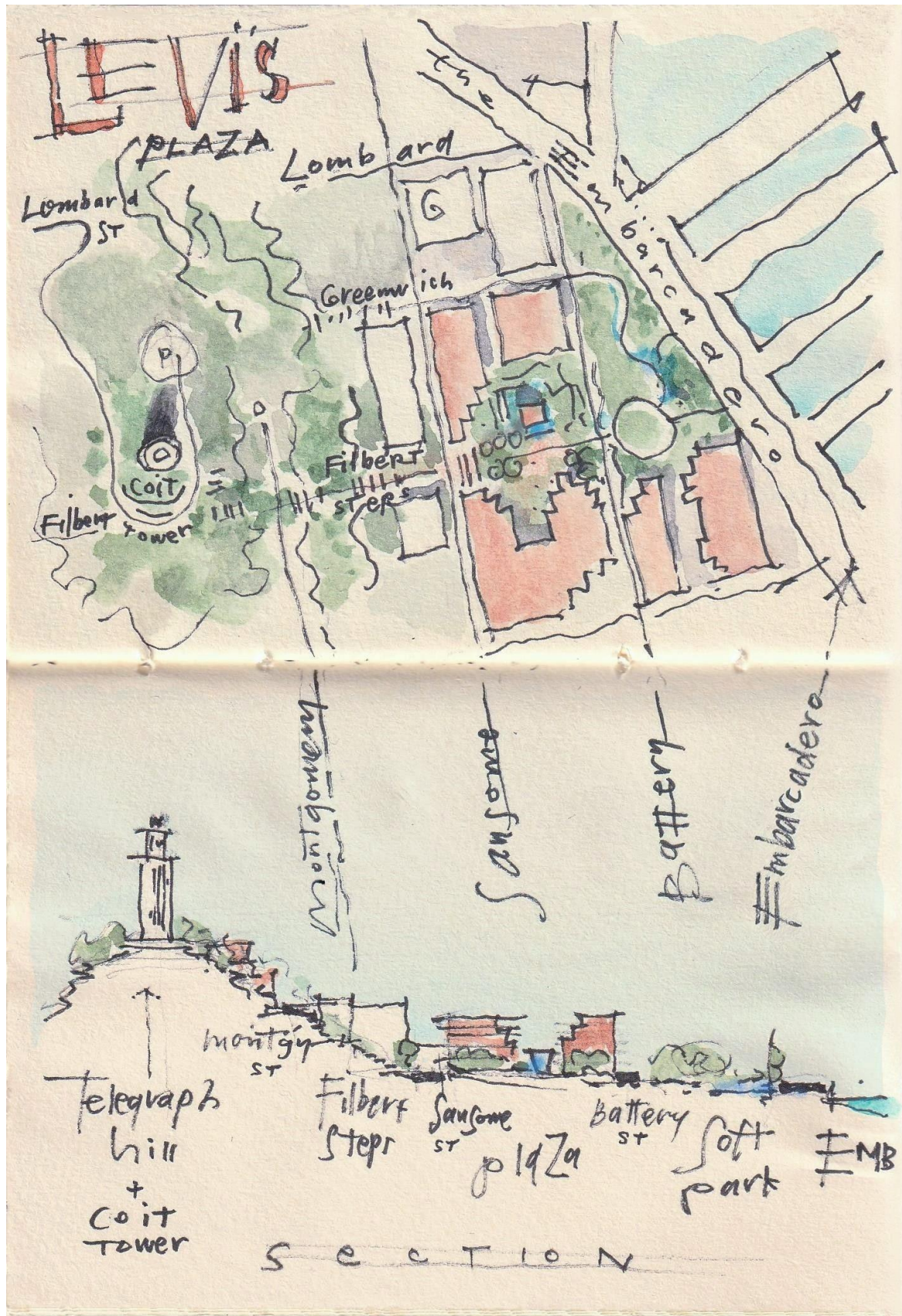

Axis down 'mountain' from Telegraph Hill to the Sansome St entrance, through fountain plaza, across Battery St into 'soft' park, emulating a 'Sierra watercourse'. Symbolic of Levi's history of making jeans for gold miners, uses gray Sierra granite blocks from the goldrush foothills

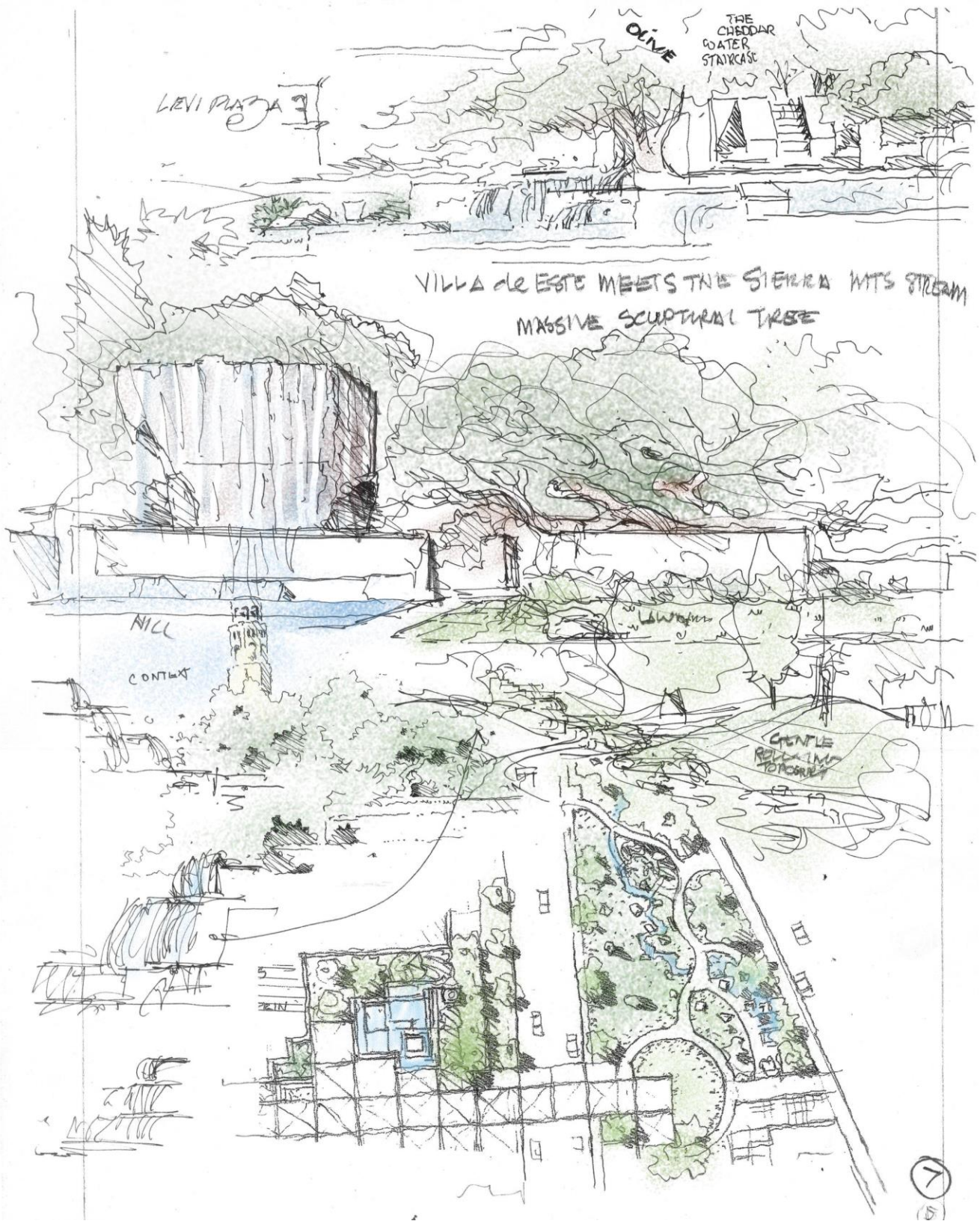

Levi's Plaza

Late 1970s by Lawrence Halprin, new HQ in heart of city, Villa d'Este meets the Sierra Nevada mountains, water passage from mountains to ocean, giant sculptural tree

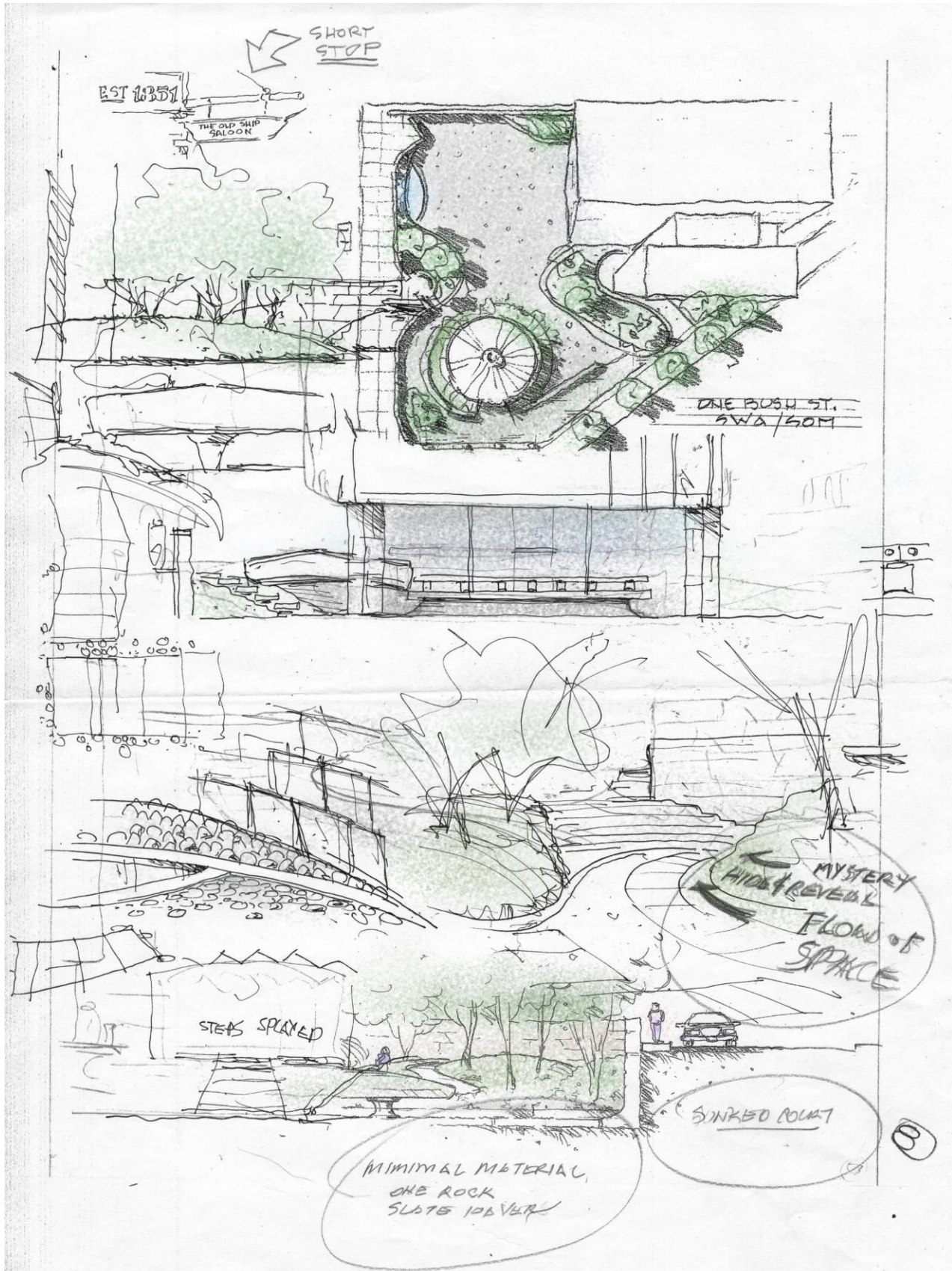

One Bush Plaza

Sunken urban court-OH NO!! , hide & reveal, much minimalism, find the Japanese Garden influences

Thanks for joining us, and don't miss our 'EXPO Drawing Jams' sessions !

ASLA 2022
DESIGNING A BETTER
FUTURE

EXPO Drawing Jams!!!

at the SKETCH booth, Moscone Center EXPO floor

November 12-13, 2022



Jim Richards on Using TONES TO CREATE Depth



Chip Sullivan on Interpreting the 'SPIRIT OF PLACE'

JOIN the SKETCH!

Field Session Team for some

DRAW-ALONG WORKSHOP JAMS

Bob Chipman on drawing people and stuff



in the
#ExpoHall

Saturday 12:30 - 2:00 pm

- and -

SUNDAY 12:15 - 1:45 pm

Richard Alomar on gestural vs. analytical drawing

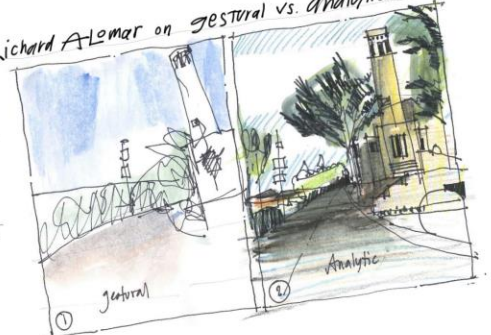

PLUS!

Nicole Warns on Hand drawing for Concept Diagrams and plans



Saturday
9:45 - 10:45 am

... And
SUNDAY
11:00 - 12:00 noon

Eric Arneson on design drawing



[and all
skill Levels!]

Verybody WELCOME!

Bring your own favorite sketching supplies! See and try the latest drawing swag from Blick!

Sponsored by
BLICK
art materials

...and don't forget to check out the SKETCH journal exhibition of the field session participants!

ASLA 2022 Conference on Landscape Architecture

San Francisco, CA