



## Technology & Equipment

### Embrace® Neonatal MRI

The Embrace® Neonatal MRI system allows clinicians to get images of our tiniest of patients quickly and quietly, without leaving the Neonatal Intensive Care Center.

The machine's customized patient bed ensures continuous delivery of thermal support throughout the scan and distributes less acoustic noise than a conventional MRI system. A full-color video display also permits continuous visual monitoring.



### GetWell Network™

The new GetWell Network™ is an interactive “edutainment” platform that helps patients and families take a more active role in their health care, allowing them to easily learn about their conditions and medications, watch movies, explore the internet, change the room temperature and more.

## Healing Environment

- **Healing Arts Program:** Site-specific art installations on the lobby floors, in the critical care units and in every patient room help uplift children as they heal.
- **Couplet Rooms:** Large and enhanced patient rooms are designed to keep mothers and babies together during their hospitalization.
- **Patient Rooms:** All patient rooms feature a pullout bed that comfortably sleeps two and a private bathroom with a shower designed to cater to a new mother's needs.
- **Lighting:** Natural light is maximized in patient rooms, which is proven to help recovery in infants, children and postpartum mothers. Patient rooms in the Neonatal Intensive Care Center utilize advanced circadian rhythm lighting to help babies develop a normal sleep pattern.



# Borowy Family Children's Critical Care Tower

The Borowy Family Children's Critical Care Tower is a seven-story, 225,000-square-foot medical building aimed at re-imagining and realizing the future of child health today. Comprised of five floors dedicated to neonatal and pediatric intensive care, the facility greatly expands the space and resources needed to treat and care for medically fragile patients. The first two floors of the building serve as the new entryway to the Baptist Medical Center Jacksonville and Wolfson Children's campuses.



Changing Health Care for Good.®



The Borowy Tower enables the growth of Wolfson Children's intensive care capabilities by providing the increased space and enhanced resources necessary to care for the region's growing number of critically ill and injured children. Updated facilities in the tower include:

- A high-level Neonatal Intensive Care Center, with three separate Neonatal Intensive Care Units (NICUs) spanning three floors and additional beds available on the 7th floor (replaces the hospital's current NICU)
  - The Neonatal Intensive Care Center is adjacent to the newly renovated Chartrand Frisch Family Birth Center, offering maternal newborn services and high-risk obstetrics
- A Pediatric Intensive Care Unit (PICU) that includes a Neuro-Intensive Care Unit (replaces the hospital's current PICU)
- A Cardiovascular Intensive Care Unit (CVICU) (relocated from Wolfson Children's J. Wayne & Delores Barr Weaver Tower)
- A Burn & Wound Care Unit

The \$224 million investment broke ground in May 2019 and involved almost three years of construction. The Borowy Tower began a phased opening with the entry level floors and Neonatal Intensive Care Center on February 22, 2022.

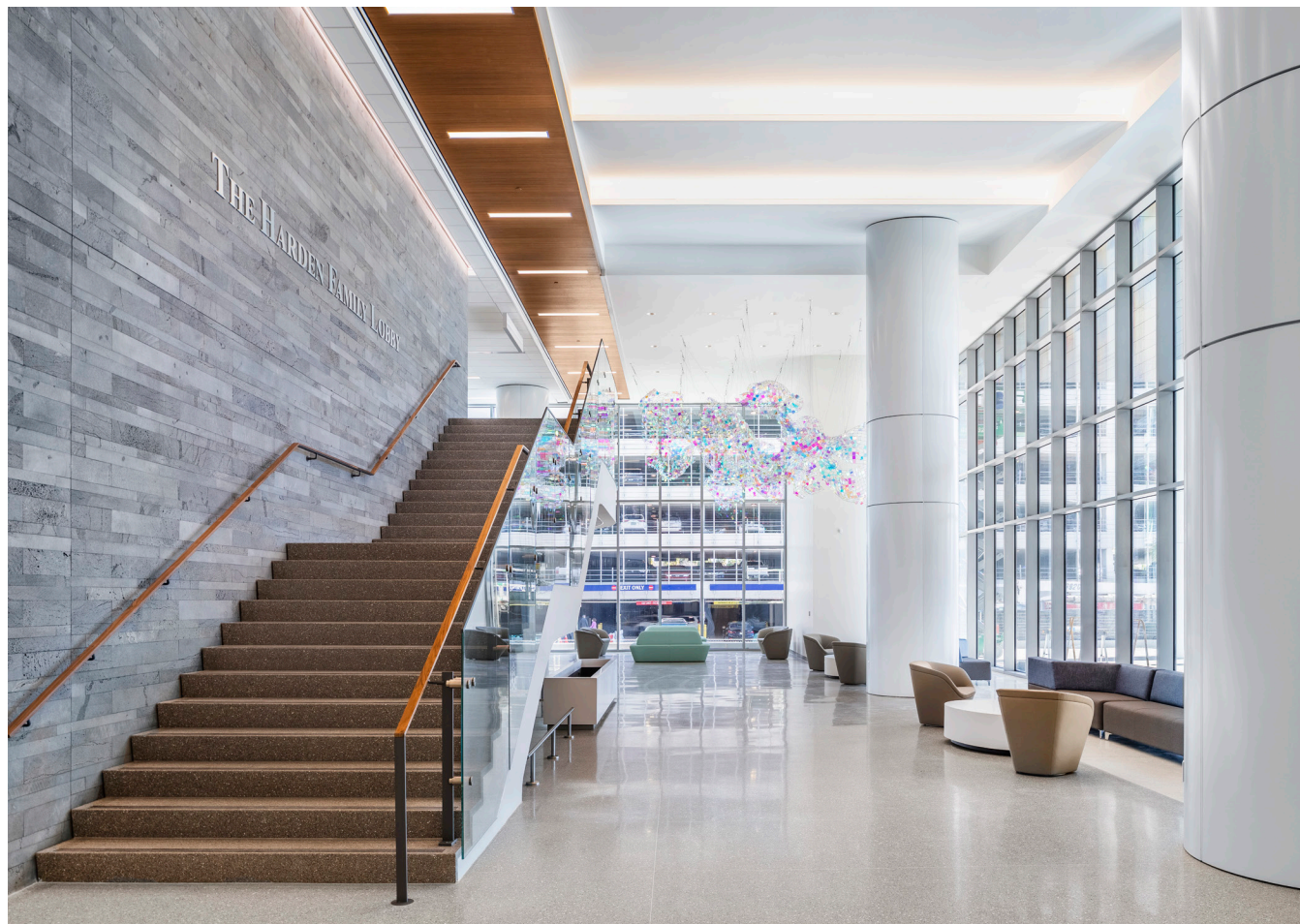

## Floor-by-Floor

### ■ 1st Floor

- Arrival court
- 4-lane drop-off plaza
- Valet service
- Dedicated ambulance bays, including one for the Kids Kare Mobile ICUs
- Harden Family Lobby
- Amanda and Ashton Hudson Welcome Center
- Sutton and Debbie McGehee Family Children's Going Home Center
- DuBow Family Foundation Elevator Lobby
- Grand staircase
- Large community room for meetings and education
- Healing Arts installation
- ERG Philanthropy Center

### ■ 2nd Floor

- Expansive lobby and atrium
- Healing Arts installation
- Connection to the P2 garage via the pedestrian Skybridge over Palm Avenue

### ■ 3rd Floor

- C. Herman and Mary Virginia Terry Neonatal Intensive Care Unit (Level IV, highest-acuity NICU)
- Access to Baptist Jacksonville Labor & Delivery

### ■ 4th Floor

- Dr. Thomas T.W. Chiu and Anna Shi Chiu Neonatal Intensive Care Unit (*Mixed-acuity NICU*)
- Access to 4th floor of Wolfson Children's Hospital
- Embrace® Neonatal MRI

### ■ 5th Floor

- Neonatal Intensive Care Unit
- Access to 5th floor of Wolfson Children's Hospital
- Dialysis treatment rooms

### ■ 6th Floor

- Clayton J. and Harriet Kicklighter Pediatric Intensive Care Unit
- Frank and Marisa Martire Neuro-Intensive Care Unit
- Dialysis treatment rooms

### ■ 7th Floor

- Cardiovascular Intensive Care Unit
- Snyder Family Burn & Wound Care Center
- Dialysis treatment rooms

