

# Simple Steps for Preparation and Injection

For a complete guide on how to correctly prepare, mix and administer Fensolvi, visit our website at [Fensolvi.com/hcp](https://Fensolvi.com/hcp)

START  
HERE

## Prepare

Allow the product to reach **room temp.**  
59-89° F before using<sup>1</sup>



## Assemble

Follow assembly instructions provided in Prescribing Information

Syringe B (with attached gray stopper): Pull out blue plunger and insert the long white plunger rod

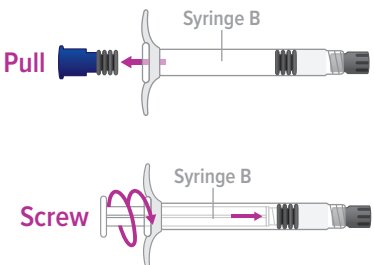

Remove caps and join the syringes

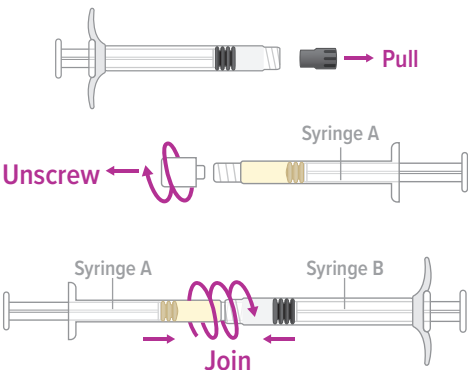

## Mix

Thoroughly mix the product for at least **45 seconds**<sup>1</sup>

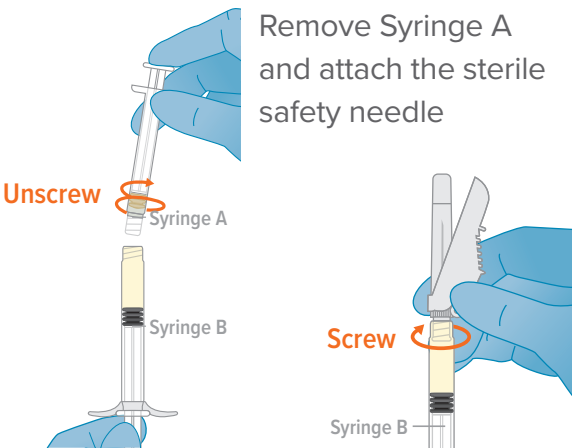
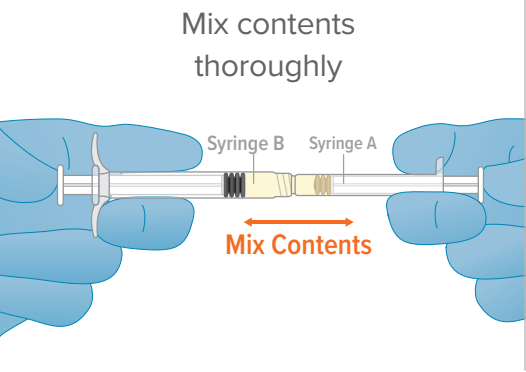

## Administer

Inject Fensolvi® at a **90° angle** into subcutaneous tissue<sup>1</sup>

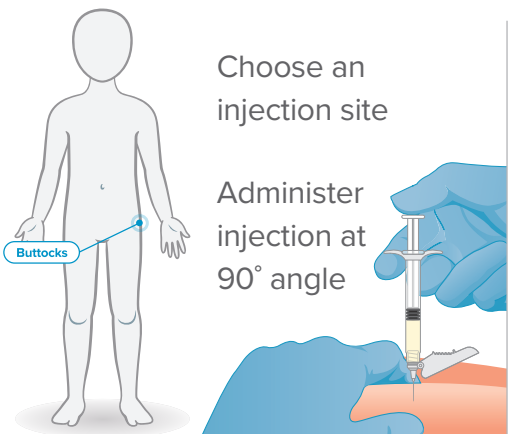

## 30 Minute Administration time limit

If the product is NOT administered within 30 minutes of mixing — it must be discarded<sup>5</sup>

Reference: 1. Fensolvi® Fensolvi® (leuprolide acetate) for injectable suspension 45 mg Prescribing Information. Dublin 2, Ireland: Tolmar International, Ltd.; 2020

fensolvi®  
(leuprolide acetate) for injectable suspension



A Guide to Correct  
**Preparation,  
Mixing and  
Administration  
of Fensolvi®**



© 2021 Tolmar Pharmaceuticals, Inc. All rights reserved.  
Tolmar, Fensolvi and their associated logos are trademarks of the Tolmar Group. Printed in USA. TPI.2020.2297.v2 01/22



For more information, watch the Fensolvi Product Video—  
Scan this QR code with your smartphone's camera.

fensolvi®  
(leuprolide acetate) for injectable suspension

Keep Childhood Simple • [Fensolvi.com/hcp](https://Fensolvi.com/hcp)

# Correct Preparation, Mixing and Administration of Fensolvi®<sup>1</sup>

## Handling and Preparation

**IMPORTANT:** Fensolvi must be brought to room temperature before mixing.

Once removed from refrigeration, Fensolvi can be stored in the original packaging for **up to 8 weeks**.

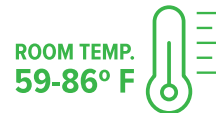

- Make sure patient is in the treatment room, as Fensolvi must be administered within 30 minutes following mixing.
- Always wash your hands and use gloves.

## Assembly at room temperature

### 1 Open both Fensolvi packages

On a clean field open both trays, discard the desiccant packs from each package and ensure all contents are in place. You are now ready to assemble and mix Fensolvi.

### 2 Start with Syringe B: Pull out blue plunger

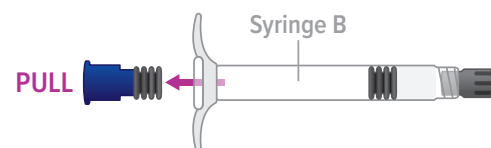

**Pull out** (do NOT unscrew) the short **blue plunger rod** with attached gray stopper from Syringe B and discard.

### 3 Insert the long white plunger rod from Syringe A package

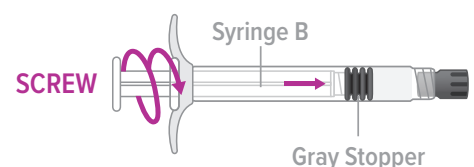

Gently screw the white plunger rod into the remaining gray stopper in Syringe B.

### 4 Remove caps

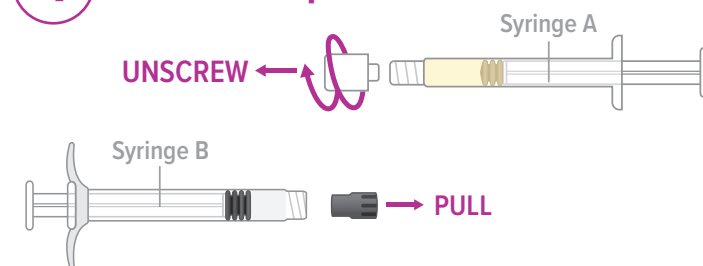

Remove and discard caps from Syringe A and Syringe B.

### 5 Join the syringes

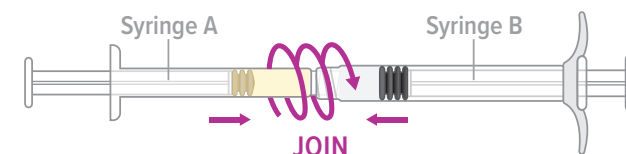

Join the two syringes together by pushing and gently screwing until secure.

## Mixing for 45 seconds

### 6 Mix contents



Inject the liquid contents of Syringe A into leuprolide acetate powder in Syringe B

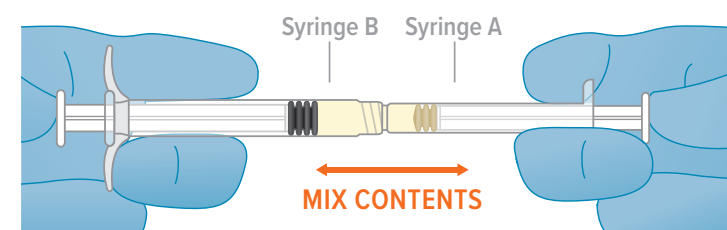

- **Thoroughly mix the product for 45 seconds** by pushing the contents back and forth to obtain a uniform suspension.
- When thoroughly mixed, the suspension will appear pale yellow.

**NOTE:** Product must be mixed as described to ensure a uniform suspension is achieved. Shaking will NOT provide adequate mixing of the product.

Fensolvi is packaged in thermoformed trays containing:

- One sterile Syringe A, prefilled with the polymeric gel delivery system
- One sterile Syringe B, prefilled with leuprolide acetate powder
- One long white plunger rod for use with Syringe B
- One sterile safety needle
- Desiccant pack(s)

### 7 Draw all mixed product into Syringe B

Hold the syringes vertically (upright) with Syringe B on the bottom. The syringes should remain securely coupled. Draw all of the mixed product into Syringe B by depressing the Syringe A plunger and slightly withdrawing the Syringe B plunger.

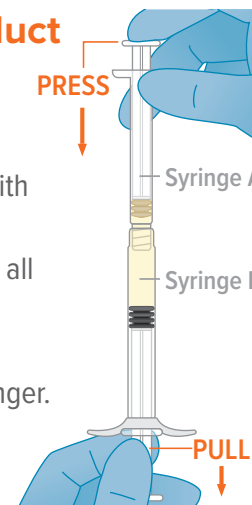

### 8 Uncouple syringes

Unscrew Syringe A to decouple the syringes while continuing to withdraw the Syringe B plunger.

**NOTE:** Small air bubbles will remain in the formulation – this is acceptable.

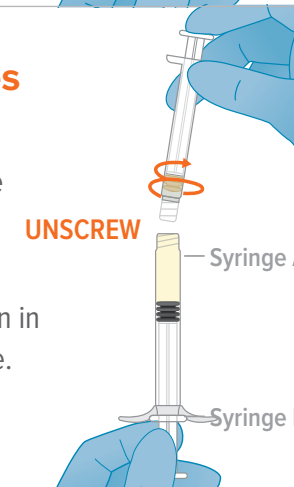

### 9 Attach the sterile needle provided

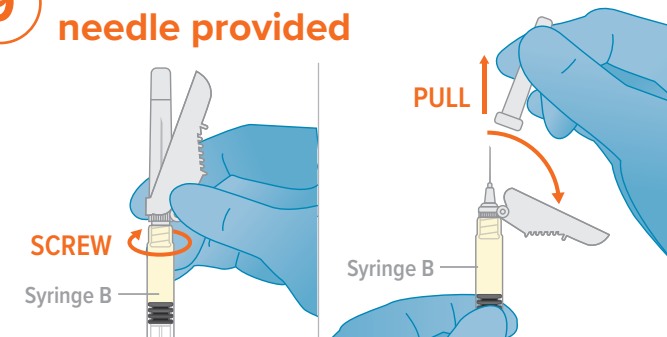

Hold Syringe B upright. Hold back the white plunger on Syringe B to prevent loss of the product. Attach the safety needle cartridge. Gently screw clockwise with approximately a three-quarter turn until the needle is secure. **Do not overtighten.**

1. Move the safety sheath away from the needle.
2. Pull off the clear needle cartridge cover, immediately prior to administration.

**NOTE:** Should the needle hub appear to be damaged, or leak, do not use the product. If the needle hub is damaged or leakage is observed, use a new Fensolvi carton.

## Administration via Subcutaneous Injection

### 10 Choosing an injection site

- Select an injection site on the upper buttocks or anywhere with adequate amounts of subcutaneous tissue that does not have excessive pigment, nodules, lesions, or hair. Avoid areas with brawny or fibrous subcutaneous tissue or locations that could be rubbed or compressed.
- Cleanse the area with an alcohol swab (not included).

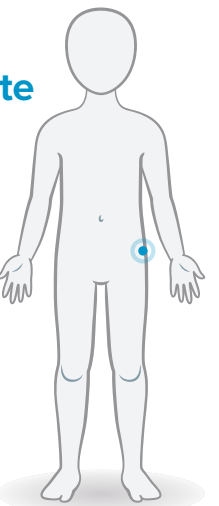

### 11 Administer injection

- Using the thumb and forefinger of your non-dominant hand, grasp an area of skin around the injection site.
- Using your dominant hand, insert needle at a 90° angle and quickly release the skin. Inject the drug using a slow, steady push. Withdraw the needle quickly at the same 90° angle.

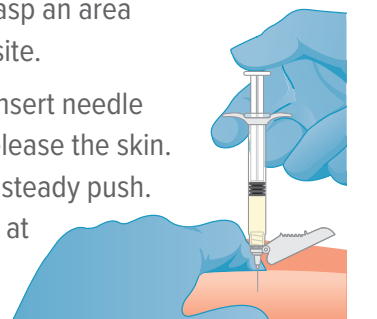
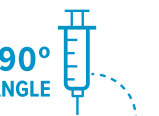

### 12 Activate needle safety shield

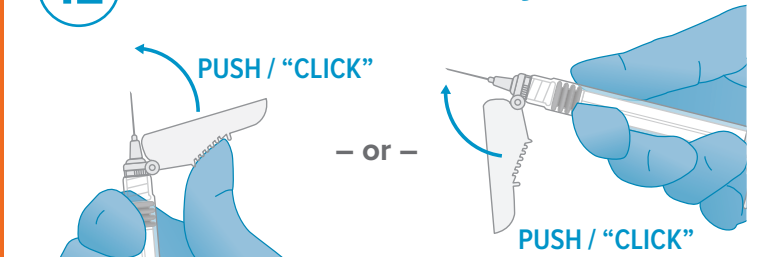

Activate the safety shield using a finger/thumb or flat surface and push until it completely covers the needle tip and locks into place. An audible and tactile “click” verifies a locked position. Check to confirm the safety sheath is fully engaged. **Discard all components safely in an appropriate biohazard container.**

Please see full Prescribing Information in pocket or visit [Fensolvi.com](http://Fensolvi.com)

**fensolvi**  
(leuprolide acetate) for injectable suspension